

Linerless label printer

FP-2000CL

NEW Release



Printing linerless label printer

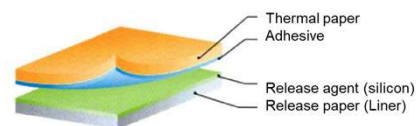

No- liner

Have you ever had a mistake like this for your customer?

Missed to pass the ordered item...

Passed the wrong item...



Linerless label printer solves these problems !

Reducing of complexity for user's operations

Example of usage cases

Restaurant, Burger Shop, Coffee shop, Fried Chicken/Pizza/Bakery Shop

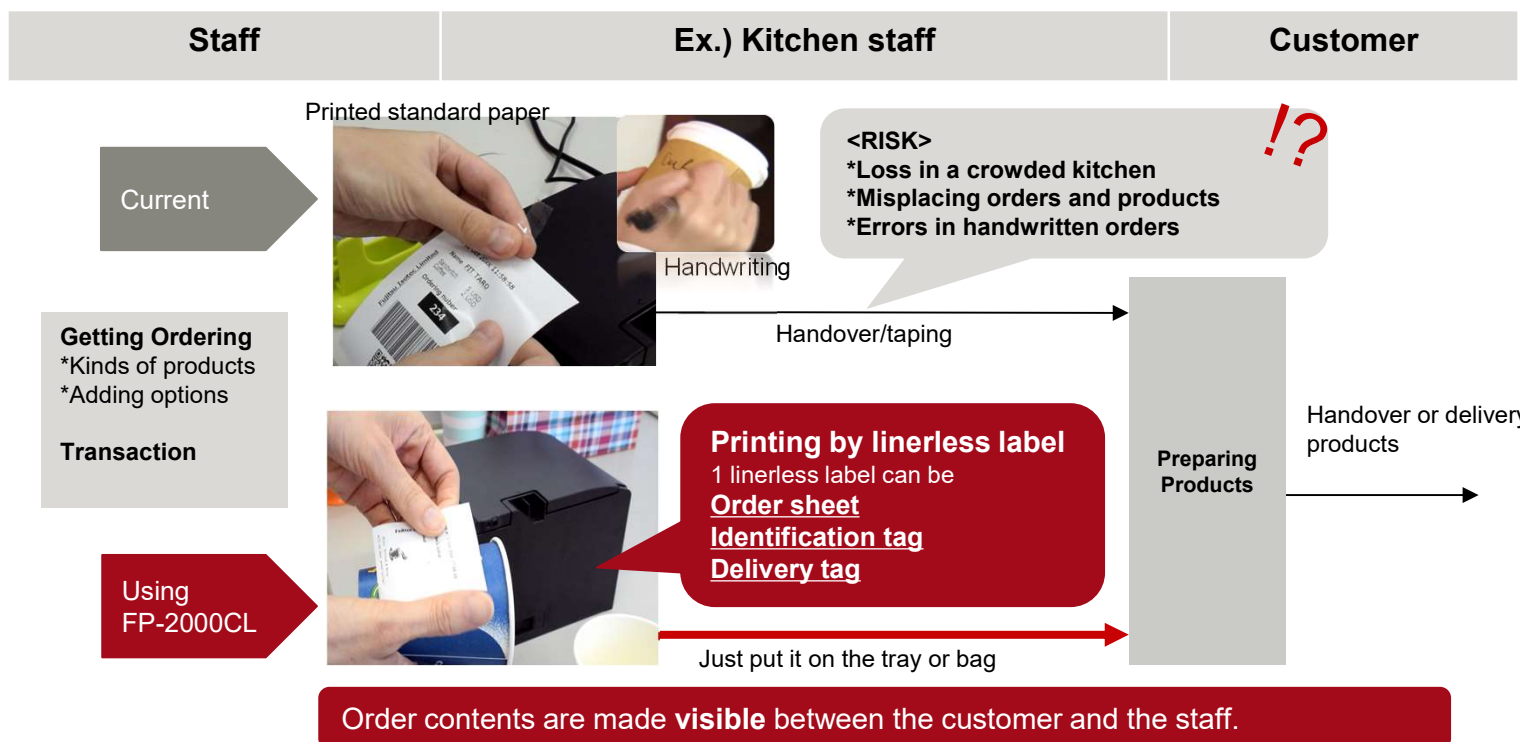

Other case: “New-normal” operation

Ticket for temperature measurement at building entrance
(Simple body temperature certificate)

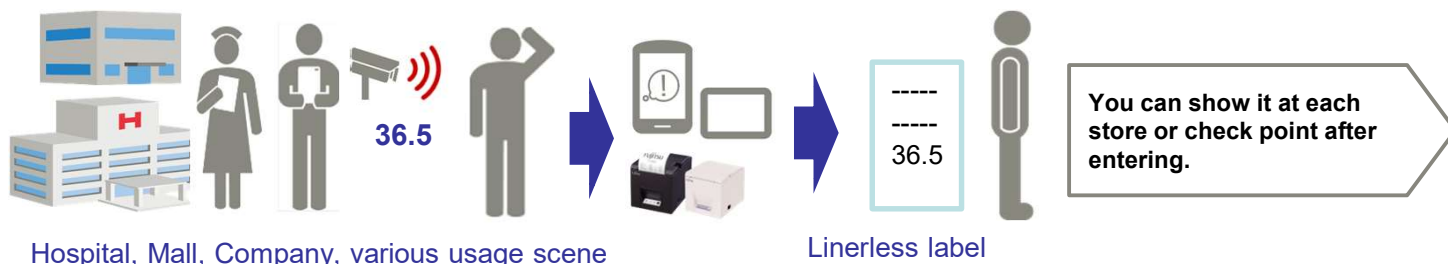

Main specifications

Printing Technology	Direct Line Thermal Method	
Print Resolution	8 dot/mm (0.125mm/dot) 203dpi	
Printing Speed (Monochrome only)	Linerless Label Paper: 150mm/s, Thermal Paper: Maximum 230mm/s	
Paper Feed-out Direction	Top feed out	
Cutter Method	Partial cut	
Installation Direction	Two ways (Horizontal / Vertical)	
Paper	Paper width: 80mm, 58mm, 50mm (Linerless Label Paper / Thermal Paper) Outer Diameter of Roll Paper: less than φ83mm (Linerless Label Paper / Thermal Paper) Paper Thickness: 84μm(Linerless Label Paper), 65μm - 85μm(Thermal Paper)	
Interface(*1)	USB(2.0 Full-speed), RS232C Serial(9pins, 25pins), Wired LAN(10BASE-T/100BASE-TX),	
Acoustic Noise	Less than 55 dB(A)	
Paper Sensors	Paper End, Paper Exit Sensor Available	
Internal Buzzer	Available to notice errors, printer status (Print Start/Print End/Paper Exit waiting)	
Software Interface	ESC/POS emulation	
Software features	180dpi font mode, 16 Gray Scale printing, Logo Store Memory Max. 1088KB, Font A (12x24dots), Font B (10x24dots or 9x24dots), Font C (8x16dots), Two-dimensional code: QR code, PDF417, DataMatrix	
Drawer Interface	2 Drawers Controllable	
MCBF (Mean-cycle-between-failure)	Linerless Label Paper: 30million lines / Thermal Paper: 60million Lines	
MTBF	Main Board : 360,000H	
Printer Mechanism Life	10 million line-feed	
Consumable Life	Print Head	Linerless Label Paper: 75km / Thermal Paper: 150km
	Cutter (*)	Linerless Label Paper: 0.3million cuts / Thermal Paper: 1.5million cuts
Power Requirements	24V±10% (AC Adapter) 100 - 240V, 50/60Hz, Single Phase	
Power Consumption (USB I/F only)	during standby: 1 W or less / 40 mA / Average during operating : 30 W or less / 1 A	
Ambient Temperature	Operation guarantee: 0 °C to 40°C / Print quality guarantee: 5 °C to 35°C	
Relative Humidity	Operation guarantee: 10 % RH to 95% RH / Print quality guarantee: 10 % RH to 85% RH	
Dimensions	5.0(W)x6.8(D)x4.9(H) inch	
Weight (without the packing box)	Under 1.0kg	
Cover Color	Ocean Black & Royal White	
Software	Windows Driver, Printer Utility, SDK(Android, iOS)	

Fujitsu Isotec Ltd.
 135 Higashinozaki, Hobara, Date-shi, Fukushima,
 Japan 960 -0695
 TEL: +81-24-574-2263 Fax: +81-24-574-2382
 Email: fit-gsm@cs.jp.fujitsu.com